

MB EC 250

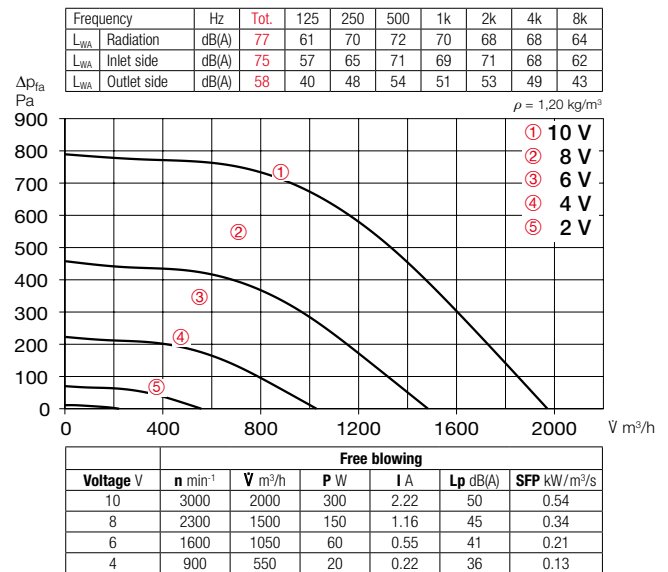

Performance curves MBW EC 250



Dimensions MB EC 250

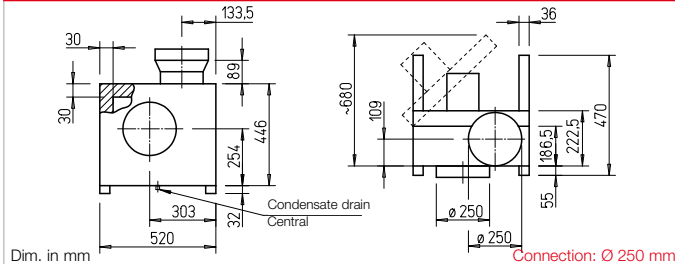

■ Casing

Double-walled, made of galvanised steel sheet. Sound insulated by lining with 30 mm thick mineral wool insulation boards. Duct connectors on inlet side and outlet side, with rubber lip seal, adapted to standard diameter. Motor-impeller unit fully retractable for inspection and cleaning, suspended on stable hinges. Comes with condensate drain and drip protection with the doors open as standard. Includes mounting rails made of galvanised steel with screwed-on vibration dampers for easy installation.

■ Impeller

Backward curved, free-running high performance centrifugal impeller made of galvanised steel, mounted directly on motor shaft. High efficiency, low noise. Dynamically balanced in accordance with DIN ISO 21940-11 – quality grade 6.3.

■ Drive

Energy-saving, speed-controllable EC internal rotor motor in protection category IP55 with the highest level of efficiency, located outside of the air flow. Maintenance-free and radio interference-free, ball bearing mounted.

■ Electrical connection

Standard terminal box (IP55) mounted to external cable.

■ Motor protection

Integrated electronic temperature monitoring system for EC motor and electronics. The motor is deactivated if the maximum permissible temperature is exceeded.

■ Power control

Continuously variable speed control with potentiometer or continuously variable speed control with universal control system (see table). Performance levels are shown in the performance curve as an example.

■ Noise

The total level and range are specified above the performance diagram for:
☐ Case-radiated sound power
☐ Inlet side sound power
☐ Outlet side sound power
 The case-radiated noise as sound pressure at 1 m (free field conditions) is also specified in the type table and the table below the performance curve.

■ Accessories

Wall bracket made of galv. steel sheet.

MB-WK EC250 Ref. no. 05526

Weather protection cover made of galv. steel sheet, mounted above motor.

MB-WSD EC250 Ref. no. 01856

Flexible connecting sleeve for installation between fan and duct
☐ Max. temperature +70 °C

FM 250 Ref. no. 01672

☐ Max. temperature +120 °C

FM 250 T120 Ref. no. 01655

■ Accessory details Page

Universal control system, electronic controller, speed potentiometer 613 ff.

Type	Ref. no.	Connection Ø	Flow rate free blowing	Rated speed	Case-rad. sound pressure	Power con- sumption	Current consumption	Wiring diagram	Max. air flow temp.	Weight net aprx.	Universal control system	Speed potentiometer			
		mm	V m³/h	min ⁻¹	dB(A) at 1 m	kW	A	No.	+ °C	kg	Type	Ref. no.	flush-mounted	surf.-mounted	
													Type	Ref. no.	Type
Alternating current, 1~, 230 V, 50/60 Hz, EC motor, protection category IP55															
MBW EC 250	05843	250	1900	3000	50	0.38	3.1	1568	100	28.0	EUR EC ¹⁾²⁾ 01347	PU 10 ¹⁾	01734	PA 10 ¹⁾	01735

¹⁾ Multiple EC fans can normally be connected. ²⁾ Alternative electronic diff. pressure/temperature controller (EDR/ETR, No. 01437/01438) or three level speed switch (SU/SA, No. 04266/04267).