

MB EC 400

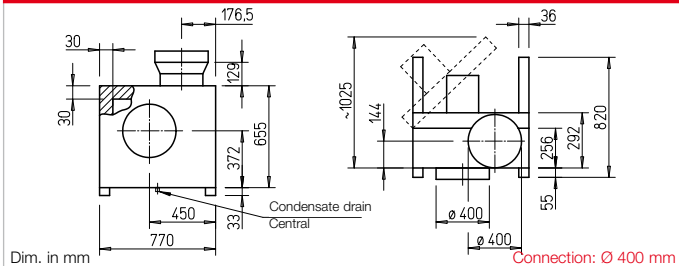

Dimensions MB EC 400



Casing

See description on page 320 for casing, impeller, drive and noise.

Electrical connection

Standard terminal box (IP55) on outside of motor.

Motor protection

Integrated electronic temperature monitoring system for EC motor and electronics. If the maximum permissible motor temperature is exceeded, the speed will be automatically reduced and then returned back to the originally set value after cooling down.

Power control

Continuously variable speed control with potentiometer or continuously variable speed control with universal control system (see table). Performance levels are shown in the performance curve as an example.

Accessories

Wall bracket

Made of galvanised steel sheet.
MB-WK EC400 Ref. no. 05528

Weather protection cover

Made of galvanised steel sheet, mounted above motor.
MB-WSD EC400 No. 01865

Flexible connecting sleeve

For installation between fan and duct.
 – Max. temperature +70 °C
FM 400 Ref. no. 01676
 – Max. temperature +120 °C
FM 400 T120 Ref. no. 01659

Performance curves MBD EC 400 A

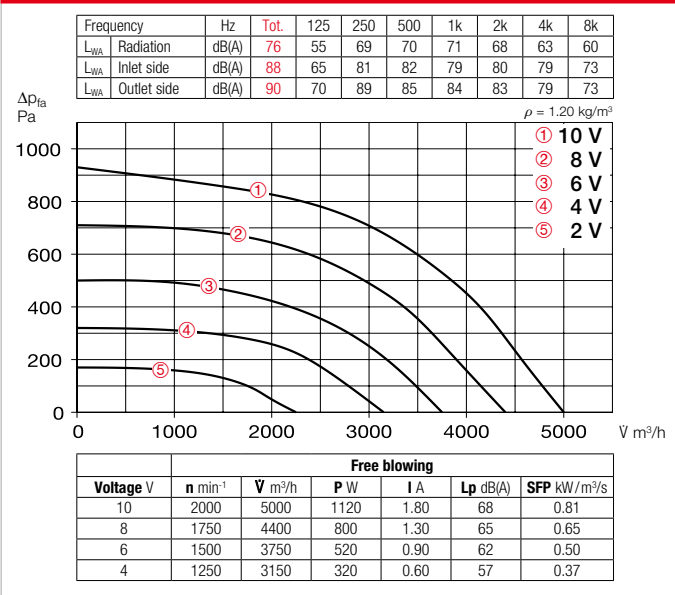

Performance curves MBD EC 400 B

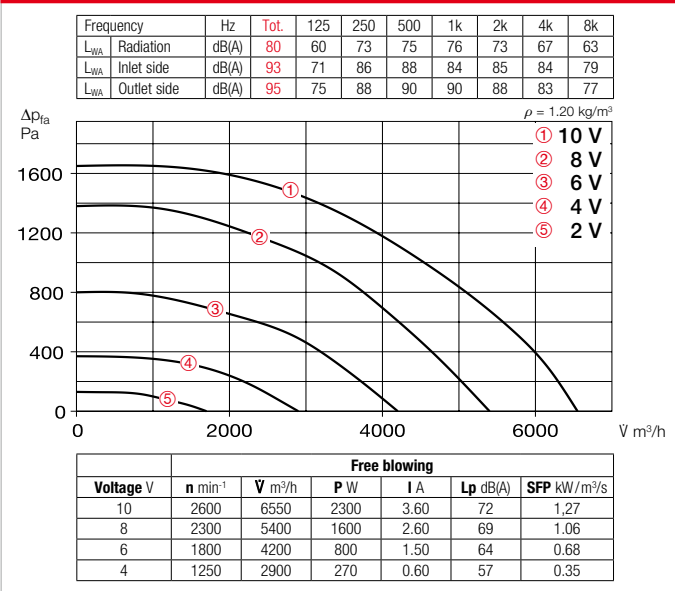

Accessory details	Page
Universal control system, electronic controller, speed potentiometer	613 ff.

Type	Ref. no.	Connection Ø	Flow rate free blowing	Rated speed	Case-rad. sound pressure	Power consumption	Current consumption	Wiring diagram	Max. air flow temp.	Weight net aprx.	Universal control system		Speed potentiometer		
											Type	Ref. no.	Type	Ref. no.	Type
Three-phase current, 3~, 400 V, 50/60 Hz, EC motor, protection category IP55															
MBD EC 400 A	05855	400	5000	2000	68	1.30	2.00	988	120	65.0	EUR EC ¹⁾²⁾ 01347	PU 10 ¹⁾	01734	PA 10 ¹⁾	01735
MBD EC 400 B	05848	400	6550	2600	72	2.65	4.10	988	120	72.0	EUR EC ¹⁾²⁾ 01347	PU 10 ¹⁾	01734	PA 10 ¹⁾	01735

1) Multiple EC fans can normally be connected. 2) Alternative electronic diff. pressure/temperature controller (EDR/ETR, No. 01437/01438) or three level speed switch (SU/SA, No. 04266/04267), see accessories.