

ZLA 125



ZLA 125 – External view



The new supply air units ZLA from Helios easily provide fresh air – fully automatically. With these universally usable automatic units, the supply air flowing inside is perfectly distributed, filtered (class ISO Coarse 30 %) and optimally sound-insulated.

The ZLA 125 consists of an inner panel, installation kit and facade panel, it fits in all types of wall and comes without electrical connection. It is available with two constant volume inner panels (22 m³/h and 30 m³/h) as well as a humidity-controlled inner panel (6 – 45 m³/h).

Advantages

- ☐ High sound-insulation due to integrated sound-insulating element (up to 56 dB standard sound level difference)
- ☐ Humidity-controlled (with ZLA 125 IB HY) or constant supply air volume (with ZLA 125 IB 22 + 30)
- ☐ Universally useable in all wall types.
- ☐ Particularly installation-friendly due to removable plastic telescopic tube for wall thicknesses from 260 to 500 mm.
- ☐ Low maintenance costs.
- ☐ Easily replaceable filter.
- ☐ Completely operating cost-free.
- ☐ No electrical connection necessary.
- ☐ Insect screen included in standard scope of delivery.

Function

- ☐ The humidity-controlled inner panel ZLA 125 IB HY 6 – 45 automatically reacts to varying room humidity levels and then adjust the flow rate in the range from 6 to 45 m³/h (at 20 Pa pressure level). See performance curve (humidity-controlled).
- ☐ The inner panels ZLA 125 IB 22 and 30 are self-regulating and keep the flow rate constant, even in case of varying differential pressure levels. See performance curve (constant supply air volume).
- ☐ All inner panel types also include ISO Coarse 30 % filters, which are easy to maintain.
- ☐ The additional components, such as the installation kit and facade panel, are easy to install and include sound-insulating elements for optimal sound insulation.
- ☐ A standard sound level difference of up to 59 dB can be achieved for a wall thickness of 500 mm using an additional sound-insulating element ZLA 125 SE.

Installation

- ☐ Installation in wall openings with a diameter of ≥ 130 mm.
- ☐ Insert telescopic tube, adjust to wall thickness, foam-seal at a slight angle and secure protective cover.
- ☐ Plaster tube into place and screw on the facade panel from outside.
- ☐ Optional: Insert insect screen in facade panel, insert ISO Coarse 30 % filter in inner panel.

Technical data

Set ZLA 125	ZLA 125 IB 22 + ZLA 125 RS + ZLA 125 FB	ZLA 125 IB 30 + ZLA 125 RS + ZLA 125 FB	ZLA 125 IB HY 6-45 + ZLA 125 RS + ZLA 125 FB
Airflow (at 4 Pa differential pressure) in m ³ /h	11.3	14.3	2.2 – 20.1
Airflow (at 8 Pa differential pressure) in m ³ /h	16.2	20.5	3.2 – 28.5
Airflow (at 20 Pa differential pressure) in m ³ /h	22	30	6 – 45
Standard sound level diff. $D_{n,e,w}$ in dB	56	55	54
Standard sound level diff. $D_{n,e,w}$ in dB incl. ZLA 125 SE	59	58	57
Pipe DN Ø in mm	125	125	125
Core drilling Ø in mm	≥ 130	≥ 130	≥ 130
Weight appr. kg	1.15	1.15	1.13

■ Inner panel 22/30 m³/h

ZLA 125 IB 22 Ref. no. 04393
ZLA 125 IB 30 Ref. no. 04394

Inner panel constant volume 22 m³/h or 30 m³/h (at 20 Pa differential pressure). Made of white plastic, ISO Coarse 30% filter.

ZLA 125 IB 22/30



Dimensions ZLA 125 IB 22/30

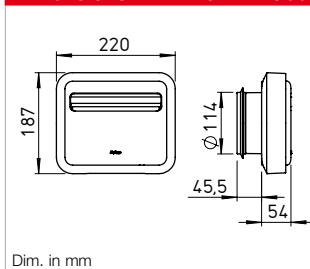

P-Curves ZLA 125 IB 22/30

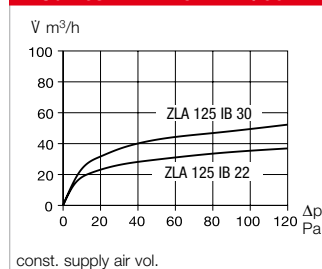

■ Inner panel humidity-controlled

ZLA 125 IB HY 6 - 45 No. 04395

Inner panel humidity-controlled between 6 - 45 m³/h (at 20 Pa differential pressure). Made of white plastic, ISO Coarse 30% filter.

ZLA 125 IB HY 6-45



Dimensions ZLA 125 IB HY 6-45

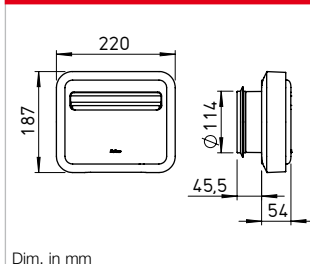

P-Curves ZLA 125 IB HY 6-45

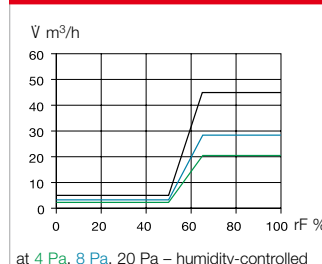

■ Installation kit

ZLA 125 RS Ref. no. 04396
 Telescopic tube 260 - 500 mm made of white plastic, incl. sound-insulating element 200 mm made of melamine resin foam, incl. 2x protective covers.

ZLA 125 RS



Dimensions ZLA 125 RS

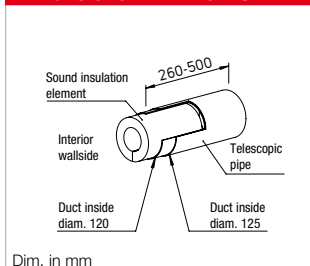

■ Sound-insulating element

ZLA 125 SE Ref. no. 04397
 Sound-insulating element 200 mm made of melamine resin foam. Can also be used for wall thicknesses ≥ 300 mm.

ZLA 125 SE



Dimensions ZLA 125 SE

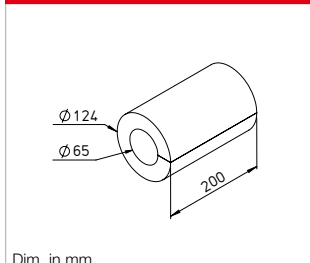

■ Facade panel

ZLA 125 FB Ref. no. 04398
 Facade panel made of white plastic for external use, insect screen made of stainless steel.

ZLA 125 FB



Dimensions ZLA 125 FB

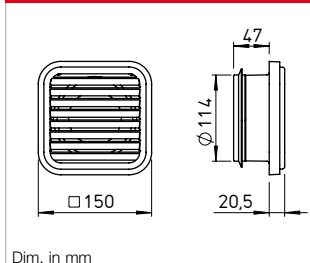

■ Spare air filter

ELF-DLV 125 Ref. no. 03058
 5 spare filters ISO Coarse 30% for inner panel.

ELF-DLV 125



■ Order info:

A complete supply air unit consists of an inner panel, an installation kit and a facade panel. Sound-insulating elements are used for wall thicknesses ≥ 300 mm.