

MB 400

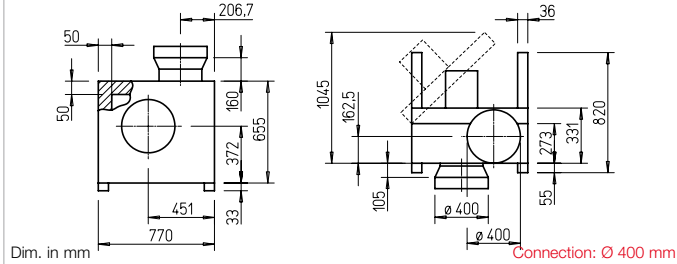

Dimensions MB 400



Casing

See page 322.

Impeller

Backward curved high performance centrifugal impeller made of aluminium, mounted directly on motor shaft.

High efficiency, low noise, aerodynamically optimised volute casing.

Dynamically balanced in accordance with DIN ISO 21940-11 – quality grade 6.3.

Drive

Through maintenance-free, speed-controllable IEC flange motor in protection category IP55. Ball bearing mounted, radio interference-free.

Electrical connection

Standard terminal box (IP55) mounted to external cable, on outside of motor for type MBD 400/2/2.

Motor protection

With external thermal contacts on the terminal block, which must be wired to the motor protection circuit breaker.

Power control

All types are speed-controllable using voltage reduction by means of transformer (accessories). The 3~ types can also be operated at two speeds using a Y/Δ switch or motor protection circuit breaker M 4. Performance levels are shown in the performance diagram.

Accessories

Wall bracket made of galv. steel sheet.

MB-WK 400 Ref. no. 05528

Weather protection cover (galv. steel sheet), mounted above motor.

MB-WSD Ref. no. 01856

Performance curves MBW 400/4

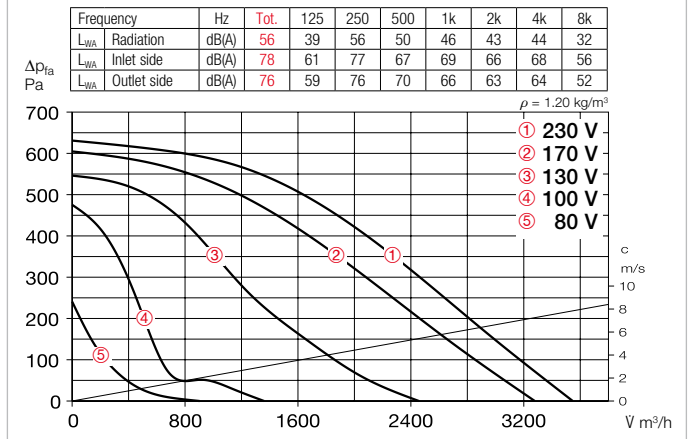

Performance curves MBD 400/4/4

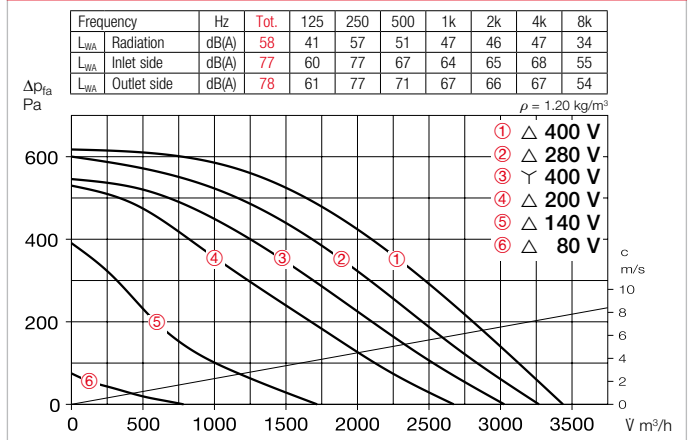

Performance curves MBD 400/2/2

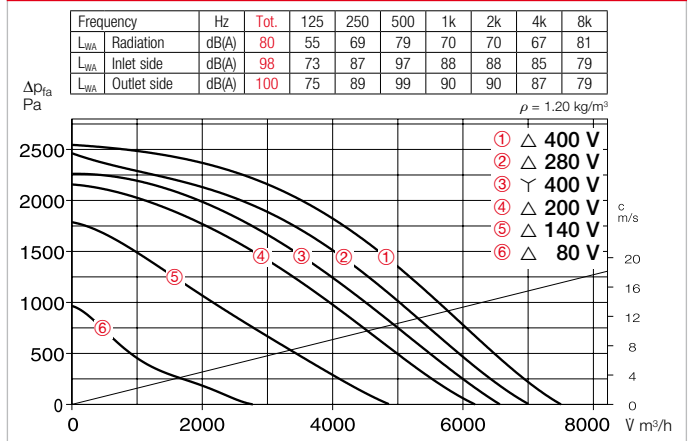

Flexible connecting sleeve for installation between fan and duct.

FM 400 (+70 °C) No. 01676

FM 400 T120(+120 °C) No. 01659

Speed switch and on/off switch for two-speed Y/Δ switchable three-phase current fans.

DS 2³⁾ Ref. no. 01351

Type	Ref. no.	Flow rate free blowing	Rated speed	Case-rad. sound pressure	Power consumption	Current consumption		Wiring diagram	Max. air flow temperature		Weight net appr.	Transformer speed controller 5-step				Mot. prot. circ. break. for connecting built-in thermal contacts	
						at rated voltage	in contr. mode		Rat. vol..	Control		kg	with motor prot. circuit breaker	w/o motor prot. circuit breaker	Type		Ref. no.
		V m³/h	min⁻¹	dB(A) at 1m	kW	A	A	No.	+ °C	+ °C		Type	Ref. no.	Type	Ref. no.	Type	Ref. no.
Alternating current, 230 V, 50 Hz, Capacitor motor, protection category IP55																	
MBW 400/4	05953	3550	1410	48	0.49	2.50	3.70	1119	100	60	85.0	MWS 5	01949	TSW 7.5	01596	MW 1)	01579
Two-speed, three-phase current motor, 400 V, 50 Hz, Y/Δ connection, protection category IP55																	
MBD 400/4/4	05955	3030/3440	1180/1410	46/50	0.41/0.50	0.71/1.00	1.30	520	100	60	82.0	RDS 2	01315	TSD 1.5 3)	01501	M 4 2)	01571
MBD 400/2/2	05949	6570/7500	2510/2840	71/74	3.10/3.70	4.80/6.10	9.00	520	100	60	110.0	RDS 11	01332	TSD 11 3)	01513	M 4 2)	01571

1) Incl. operating switch.

2) Incl. operating and speed switch.

3) Req. motor protection circuit breaker: Type MD, No. 05849.