

MB 280



(Fig. similar)

Also available in version:



Dimensions MB 280

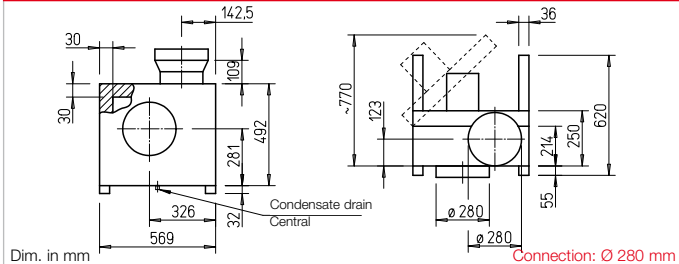

Casing

See page 320.

Impeller

Backward curved high performance centrifugal impeller made of aluminium, forward curved and made of galvanised steel for explosion-proof types. Dynamically balanced together with the motor. High efficiency, low noise, aerodynamically optimised casing.

Drive

Through maintenance-free, speed-controllable IEC flange motor in protection category IP55. Ball bearing mounted, radio interference-free.

Electrical connection

Standard terminal box (IP55) mounted to external cable, on outside of motor for explosion-proof types.

Motor protection

With external thermal contacts on the terminal block, which must be wired to the motor protection circuit breaker.

Power control

See page 320.

Accessories

Wall bracket made of galv. steel sheet.

MB-WK EC280 Ref. no. 05527

Wall bracket for Ex types.

MB-WK 280 Ref. no. 05527

Weather protection cover (galv. steel sheet), mounted above motor.

MB-WSD Ref. no. 01856

Performance curves MBD 280/2/2

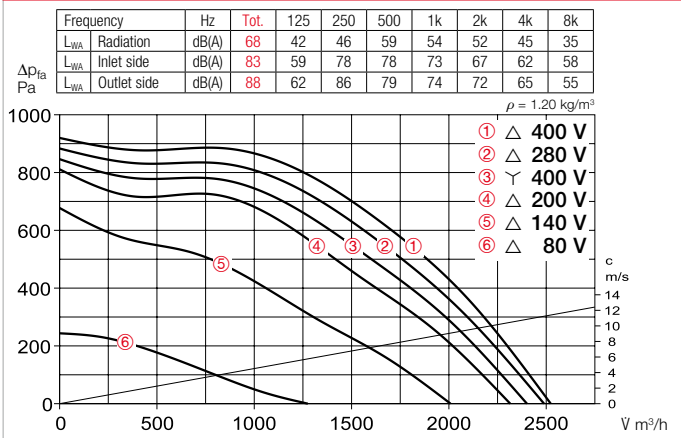

Performance curves MBD 280/6 Ex

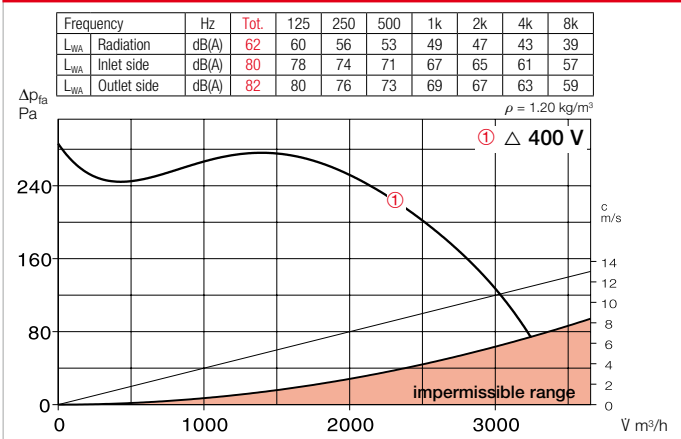

Performance curves MBD 280/4 Ex

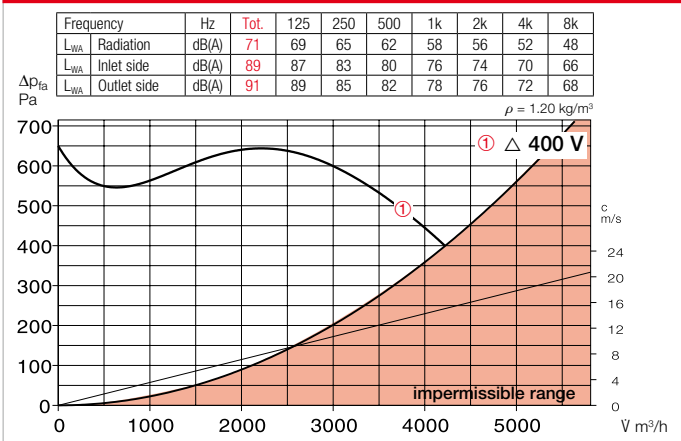

Flexible connecting sleeve for installation between fan and duct.

FM 280 (+70 °C) No. 01673

FM 280 T120 (+120 °C) No. 01656

FM 315 Ex No. 01690

Speed switch and on/off switch for two-speed Y/Δ switchable three-phase current fans.

DS 2²⁾ Ref. no. 01351

Type	Ref. no.	Flow rate free blowing	Rated speed	Case-rad. sound pressure	Power consumption*	Current consumption*		Wiring diagram	Max. air flow temperature		Weight net appr.	Transformer speed controller 5-step				Mot. prot. circ. break. for connecting built-in thermal contacts	
						at rated voltage	in contr. mode		Rat. vol.	Control		with motor prot. circuit breaker	w/o motor prot. circuit breaker	Type	Ref. no.		Type
		V m³/h	min⁻¹	dB(A) at 1m	kW	A	A	No.	+ °C	+ °C	kg	Type	Ref. no.	Type	Ref. no.	Type	Ref. no.
Two-speed, three-phase current motor, 400 V, 50 Hz, Y/Δ connection, protection category IP55																	
MBD 280/2/2	06460	2400/2520	2680/2890	56/60	0.48/0.57	0.80/1.50	1.60	520	100	60	35.0	RDS 2	01315	TSD 3.0³⁾	01502	M 4¹⁾	01571
Explosion-proof, II 2G Ex h IIB T3 Gb, motor Ex e, three-phase current 400 Volt, 50 Hz, protection category IP55																	
MBD 280/6 Ex³⁾	06016	2960	960	56	0.95	2.70	-	498	40	-	60.0	Not permitted		Not permitted		-	
MBD 280/4 Ex³⁾	06017	4960	1420	65	2.00	4.65	-	498	40	-	68.0	Not permitted		Not permitted		-	

* For Ex types: Motor ratings, see info p.20. ¹⁾ Incl. operating and speed switch. ²⁾ Req. motor prot. circuit breaker: Type MD, No. 05849. ³⁾ Dim. drawing at www.HeliosSelect.de.